

 **ANCHOR**

by **Panasonic**

PENTA

**AN
INTEGRAL
PART OF
EVERY
FAMILY.**

INDIA'S LARGEST SELLING SWITCH



PRICELIST: JULY 2022

PENTA PC

Code White	Code Ivory	Code Dark Brown	Description	HSN	Unit Sale Price Rs per number	Standard Packing Quantity (Number)	Maximum Retail Price (Inclusive of all taxes) Rs.
PENTA DELUXE, 240V~ 50Hz (ISI)							
14111	-	-	6A, 1 Way Switch	85361010	21	30	630
14112	-	-	6A, 2 Way Switch	85361010	41	30	1230
14113	-	-	6A, Bell Push Switch	85361010	41	30	1230
14125	-	-	6A, 1Way Switch Urea Back piece(IP20)	85361010	21	30	630
PENTA CHERRY, 240V~ 50Hz (ISI)							
14121	-	-	6A, 1 Way Switch	85361010	22	30	660
14122	-	-	6A, 2 Way Switch	85361010	43	30	1290
14123	-	-	6A, Bell Push Switch	85361010	43	30	1290
14126	-	-	6A, 1Way Switch Urea Back piece(IP20)	85361010	22	30	660
SOCKETS, 240V~ 50Hz							
14301*	-	-	6A, 2 Pin Socket	85366910	38	20	760
14312*	-	-	6A, 2 Pin Socket Urea Backpiece (IP20)	85366910	38	20	760
14302	-	-	6A, 3 Pin Socket ISI	85366910	41	10	410
14303*	-	-	6A, Multi Socket For 2 & 3 Pin	85366910	53	10	530
14305*	-	-	6A/13A Combine Socket (For All Kind Of Pins)	85366910	75	10	750
14119*	-	-	6A, 2in1 Socket Urea Backpiece (IP20)	85366910	41	20	820
*Limited Stock, to be discontinued.							
SUPPORT FUNCTION							
14309	-	-	USB-A Charger, Single Port(1A, 5V DC), 1 Module	85044090	678	10	6780
14609	-	-	10A & 16A Kit Kat Fuse Flush	85361060	69	10	690
TELEPHONE JACK / NEON LAMP INDICATOR / COMPUTER JACK							
14601	-	-	Neon Indicator 240V~ 50Hz	85311090	58	20	1160
14602	-	-	Mini Tel. Jack With Shutter	85366910	96	20	1920
14603	-	-	Telephone Jack Double W/O Shutter	85366910	121	10	1210
TV ANTENNA OUTLET							
14606	-	-	T.V. Outlet Mini	85366910	60	20	1200
14607	-	-	T.V. Outlet Deluxe	85366910	66	10	660



PENTA PC

Code White	Code Ivory	Code Dark Brown	Description	HSN	Unit Sale Price Rs per number	Standard Packing Quantity (Number)	Maximum Retail Price (Inclusive of all taxes) Rs.
FAN REGULATOR, 240V~ 50Hz							
14501	-	-	100W,Mini Fan Regulator Rotary Step	84149030	275	10	2750
14502	-	-	100W,Deluxe Fan Regulator Rotary Step	84149030	307	10	3070
DIMMER CONTROLLER, 240V~ 50Hz							
14503	-	-	450W, Mini Dimmer	85365020	261	10	2610
14504	-	-	450W, Delux Dimmer	85365020	284	10	2840
POWER SWITCHES (2 FIXING HOLES), 240V~ 50Hz (ISI)							
14401	-	-	20A, 1 Way Switch	85361020	107	10	1070
14402	-	-	20A, 2 Way Switch	85361020	141	10	1410
14404	-	-	32A DP Switch W/o Fuse With Neon	85361020	229	10	2290
POWER SOCKETS (2 FIXING HOLES), 240V~ 50Hz (ISI)							
14307	-	-	6A/16A, Uni. Socket	85366910	119	10	1190
MOTOR STARTER, 240V~ 50Hz							
52660	-	-	25A, Motor Starter S.P	85369010	388	10	3880
UNI SWITCH SOCKET COMBINED UNITS, 240V~ 50Hz							
14614	-	-	6A/16A, Combined Unit with 2 Fixing Holes	85366910	167	10	1670
14615	-	-	6A/16A, Combined Unit with 4 Fixing Holes	85366910	170	10	1700
14616	-	-	6A/16A, Combined Unit Box with Box 2 Fixing Holes	85366910	204	6	1224
14310	-	-	6A/16A, SS Combined with Box with Box 4 fixing Holes	85361020	208	6	1248
COMBINED UNIT, 240V~ 50Hz							
14617	-	-	6A/16A, Capton 5-In-1, 2 Fixing Holes	85361020	261	6	1566
14618*	-	-	6A/16A, Capton 5-In-1, 4 Fixing Holes	85361020	262	6	1572
14620	-	-	6A/16A, Capton 5-In-1, With Box 4 Fixing Holes	85361020	281	6	1686
*Not Suitable For Penta Urea Box							
COMBINED UNIT WITH PLUG, 240V~ 50Hz							
14315	-	-	6A/16A, Capton 5-In-1 With Box & 16A Plug, 4 Fixing Holes	85361020	374	6	2244

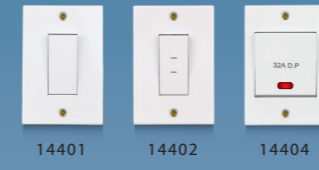

PENTA UREA

Code White	Code Ivory	Code Dark Brown	Description	HSN	Unit Sale Price Rs per number	Standard Packing Quantity (Number)	Maximum Retail Price (Inclusive of all taxes) Rs.
PENTA DELUXE, 240V~ 50Hz (ISI)							
38014	50010	38014DB	6A, 1 Way Switch	85361010	21	20	420
38058	51373	38058DB	6A, 1 Way Switch, Deluxe (IP20)	85361010	21	20	420
38025	50020	38025DB	6A, 2 Way Switch	85361010	40	20	800
38047	50042	38047DB	6A, Bell Push Switch	85361010	40	20	800
PENTA PIANO, 240V~ 50Hz (ISI)							
38069	50053	-	6A, 1 Way Switch	85361010	21	20	420
38070	50064	-	6A, 2 Way Switch	85361010	40	20	800
38091	50075	-	6A, Bell Push Switch	85361010	40	20	800
PENTA CHERRY, 240V~ 50Hz (ISI)							
38193	50144	38193DB	6A, 1 Way Switch	85361010	22	20	440
38194	50145	38194DB	6A, 1Way Switch (IP20)	85361010	22	20	440
38207	50155	38207DB	6A, 2 Way Switch	85361010	41	20	820
38218	50166	38218DB	6A, Bell Push Switch	85361010	41	20	820
PENTA SOCKETS, 240V~ 50Hz							
38331*	50235	38331DB	6A, 2 Pin Socket	85366910	36	20	720
38332*	50236	38332DB	6A, 2 Pin Socket (IP20)	85366910	36	20	720
38342	50246	38342DB	6A, 3 Pin Socket ISI	85366910	41	20	820
38364*	50279	38364DB	6A, 2-In-1 Socket	85366910	41	20	820
38320*	50938	38320DB	6A, 2-In-1 Socket (IP 20)	85366910	41	20	820
38375*	50280	38375DB	6A, Multi Socket For 2 & 3 Pin	85366910	51	20	1020
38353*	50268	-	6A,3-in-1 Socket (2Pin +3 Pin Socket)	85366910	48	20	960
38717*	50290	-	6A/10A/13A, Combi. Socket (for all kind of pins)	85366910	71	20	1420
*Limited Stock, to be discontinued.							
TELEPHONE JACK, 240V~ 50Hz							
38444	50326	38444DB	Mini Tel. Jack	85366910	91	20	1820
38455	50337	-	Delux Tel. Jack With Shutter	85366910	106	10	1060
NEON LIGHT / TV ANTENNA OUTLET, 240V~ 50Hz							
38273	50359	38273DB	Neon Night Lamp , 240V~ 50Hz	85311090	48	20	960
38400	50370	38400DB	Mini T.V. Outlet	85366910	58	20	1160
38411	50381	-	Deluxe T.V. Outlet	85366910	62	10	620
KIT KAT FUSE FLUSH, 240V~ 50Hz							
38295	50392	38295DB	10A, Mini Kit Kat Fuse	85361030	64	10	640
38309	50406	38309DB	16A Deluxe Kit Kat Fuse	85361060	74	10	740
DELUXE / S.S. COMBINED, 240V~ 50Hz							
4056	50483	-	6A, 3 Pin S.S. Comb. Deluxe	85361020	109	10	1090
38820	50494	38820DB	6A, 2-In-1 S.S. Combined Deluxe	85361020	109	10	1090
38841	50508	-	6A, 2-In-1 S.S. Combined With Box	85361020	135	5	675
38821	50495	38821DB	6A, 2-In-1 S.S. Combined (ISI) Deluxe	85361020	109	10	1090
38842	50509	38842DB	6A, 2-In-1 S.S. Combined With Box (ISI)	85361020	135	5	675

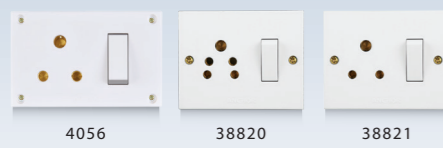
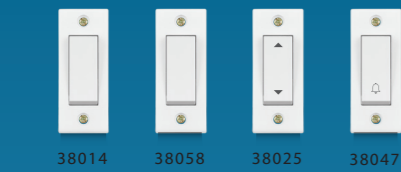

PENTA UREA

Code White	Code Ivory	Code Dark Brown	Description	HSN	Unit Sale Price Rs per number	Standard Packing Quantity (Number)	Maximum Retail Price (Inclusive of all taxes) Rs.
PENTA DELUXE SERIES, 240V~ 50Hz (ISI)							
39989	50961	-	20A, 1 Way Switch, IP20	85361020	104	10	1040
39993	50964	-	6A/16A, Uni Socket	85366910	114	10	1140
CAPTON SERIES, 240V~ 50Hz (ISI)							
39991	50962	39991DB	20A, 1 Way Switch	85361020	110	10	1100
38488	4169	38488DB	16A, 2 Way Switch	85361020	134	10	1340
38397	4170	-	16A, 3 Pin Socket	85366910	116	10	1160
39994	50965	39994DB	6A/16A, Uni Socket	85366910	116	10	1160
39992	50963	-	20A, 1 Way Switch with Box	85361020	141	10	1410
39995	50966	-	6A/16A, Uni Socket With Box	85366910	146	10	1460
CAPTAN 20 & 10A S.S COMB. WITH SHUTTER, 240V~ 50Hz							
4216	50643	-	16A, 3 Pin S.S. Combined	85361020	167	10	1670
39998	50969	39998DB	6A/16A, SS Combined with 4 Fixing Holes	85361020	171	10	1710
39999	50970	-	6A/16A, SS Combined with 2 Fixing Holes	85361020	171	10	1710
38794	4282	-	6A/16A, S.S. Combined with Neon Indicator	85361020	178	10	1780
39996	50967	-	6A/16A, S.S. Combined With JB Box with 2 Fixing Holes	85361020	208	6	1248
39593	51238	-	6A/16A, SS Combined with Box with 4 Fixing Holes	85361020	208	6	1248
5-IN-1 COMBINED UNIT, 240V~ 50Hz							
39550	51250	-	20A/10A, Euro Capton, 5-In-1 with 2 Fixing Holes	85361020	246	6	1476
38580	4920	38580DB	20A/10A, Euro Capton, 5-In-1 with 4 Fixing Holes	85361020	246	6	1476
38590	4522	-	20A/10A, Neo Capton, 5-In-1 with 4 Fixing Holes	85361020	237	6	1422
38579	51103	-	20A/10A, Capton, 5-In-1 with Box and 4 Fixing Holes	85361020	266	6	1596
39924	51351	-	20A/10A, Capton, 5-In-1 with Box & 16A ISI Plug and 4 Fixing Holes	85361020	382	6	2292
5-IN-1 COMBINED UNIT, 240V~ 50Hz, Urea Back Piece							
39981	50981	-	6A/16A, Euro Capton 5-In-1 with 2 Fixing Holes	85361020	246	6	1476
39986	50986	39986DB	6A/16A, Euro Capton 5-In-1 with 4 Fixing Holes	85361020	246	6	1476
39983	50983	-	6A/16A, Neo Capton 5-In-1 with 4 Fixing Holes	85361020	237	6	1422
39984	50984	-	6A/16A, 5 in 1 with box with 4 fixing Holes	85361020	266	6	1596
39985	50985	-	6A/16A, Capton 5-in-1 with box & 16A ISI plug, 4 Fixing Holes	85361020	382	6	2292
FAN REGULATOR, 240V~ 50Hz							
38284	50790	38284DB	100W Mini Fan Regulator	84149030	259	10	2590
38660	50440	38660DB	100W Deluxe Fan Regulator	84149030	291	10	2910
DIMMER CONTROLLER, 240V~ 50Hz							
38648	50428	38648DB	450W , Mini Dimmer	85365020	274	10	2790
38659	50439	38659DB	450W , Deluxe Dimmer	85365020	303	10	3090

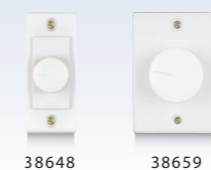
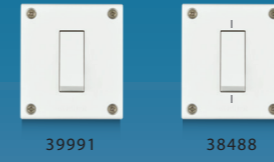
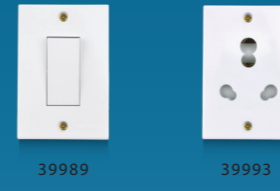

GENERAL ACCESSORIES

Code White	Code Ivory	Code Dark Brown	Description	HSN	Unit Sale Price Rs per number	Standard Packing Quantity (Number)	Maximum Retail Price (Inclusive of all taxes) Rs.
CORD SWITCHES, 240V~ 50Hz							
2527	-	-	6A, 1 Way Bed Switch	85365020	53	20	1060
2538	-	-	Cord Through	85365020	53	20	1060
2593	-	-	Hanging Bell Push Switch	85361010	53	20	1060
SUPREME FLUSH DIMMER / CONTROLLER, 240V~ 50Hz,							
8534	-	8534DB	450W, Supreme Metallic Flush	85365020	355	10	3550
8567	-	8567DB	650W, Supreme Metallic Flush	85365020	405	10	4050
CLASSIC FLUSH DIMMER / CONTROLLER, 240V~ 50Hz							
8556	-	-	650W, Dimmer Classic Flush	85365020	405	10	4050
8589	-	-	1000W, Dimmer Classic Flush	85365020	486	10	4860
OPEL SURFACE DIMMER / CONTROLLER, 240V~ 50Hz							
8410	8410IV	-	100W, Opel Fan Regulator	84149030	333	10	3330
-	8498	-	450W, Super Surface Dimmer Controller	85365020	347	10	3470
SURFACE SERIES, 240V~ 50Hz							
2301	2301IV	-	6A, Surface 1 Way Switch	85361010	43	10	430
2323	2323IV	-	6A, Surface Bell Push Switch	85361010	48	10	480
IRON CONNECTOR, 240V~ 50Hz							
6335	-	-	Front Porcelain Iron Connector (Deluxe)	85444999	96	10	960
CEILING ROSE, 240V~ 50Hz							
39017	3257	39017DB	6A, Pilot 2 Plate	94054090	29	20	580
39040	3290	39040DB	6A, Pilot 3 Plate	94054090	38	20	760
39028	3199	39028DB	6A, Jumbo 2 Plate	94054090	45	20	900
39050	3224	-	6A, Jumbo 3 Plate	94054090	48	20	960
39072	50916	51090	6A, Pilot 3 Plate ISI	94054090	38	20	760
LAMP / PENDANT HOLDER (PLASTIC RING), 240V~ 50Hz							
14706	-	-	Pendent Holder	85366110	41	30	1230
39527	51191	-	Angle Holder	85366110	43	30	1290
38538	51205	-	Batten Holder	85366110	43	30	1290

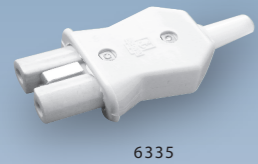
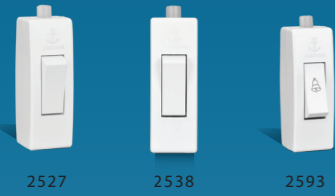

GENERAL ACCESSORIES

Code White	Code Ivory	Code Dark Brown	Description	HSN	Unit Sale Price Rs per number	Standard Packing Quantity (Number)	Maximum Retail Price (Inclusive of all taxes) Rs.
LAMP HOLDER (WITH METAL RING), 240V~ 50Hz							
39797	51169	-	Angle Holder	85366110	45	30	1350
39800	51170	-	Batten Holder	85366110	45	30	1350
ADAPTOR, 240V~ 50Hz							
6506	51180	-	Adaptor	85369090	30	20	600
D.P SWITCH WITHOUT LINK, 240V~ 50Hz (ISI)							
5081	5081IV	-	32A, Surface D.P Switch W/O Link	85361010	157	10	1570
5070	5070IV	-	32A, Flush Pilot D.P Switch W/O Link	85361010	157	10	1570
TP SWITCH WITH NEON, 240V~ 50Hz (ISI)							
5376	5376IV	-	32A, T.P Switch W/O Fuse	85361020	359	6	2154
D.P SWITCH PILOT, 240V~ 50Hz (ISI)							
39094	5037	39094DB	32A, Surface DP Switch With Neon	85361020	187	6	1122
39083	5140	39083DB	32A, Flush DP Switch With Neon	85361020	187	6	1122
UNO MINI MCB							
98236	-	-	6A, SP 'C' Mini MCB	85362030	281	12	3372
98237	-	-	10A, SP 'C' Mini MCB	85362030	281	12	3372
98238	-	-	16A, SP 'C' Mini MCB	85362030	281	12	3372
98239	-	-	20A, SP 'C' Mini MCB	85362030	281	12	3372
98240	-	-	25A SP 'C' Mini MCB	85362030	281	12	3372
98241	-	-	32A, SP 'C' Mini MCB	85362030	281	12	3372
98246	-	-	6A, DP 'C' Mini MCB	85362030	567	6	3402
98247	-	-	10A, DP 'C' Mini MCB	85362030	567	6	3402
98248	-	-	16A, DP 'C' Mini MCB	85362030	567	6	3402
98249	-	-	20A, DP 'C' Mini MCB	85362030	567	6	3402
98250	-	-	25A DP 'C' Mini MCB	85362030	567	6	3402
98251	-	-	32A, DP 'C' Mini MCB	85362030	567	6	3402



INDUSTRIAL PRODUCTS

Code White	Code Ivory	Description	HSN	Unit Sale Price Rs per number	Standard Packing Quantity (Number)	Maximum Retail Price (Inclusive of all taxes) Rs.
2 POLE D.P SHEET METAL SWITCH PILOT, 240V~ 50Hz						
17182	17616	16A, 240V Neutral Link	73269099	707	1	707
17615	17617	16A, 240V D.P	73269099	707	1	707
17626	17618	32A, 240V D.P	73269099	1302	1	1302
17692	17619	63A, 240V D.P	73269099	1977	1	1977
-	17955	32A, 240V D.P	73269099	1302	1	1302
3 POLE T.P SHEET METAL SWITCH PILOT, 240V~ 50Hz						
17637	-	16A, 415 V T.P	73269099	1415	1	1415
17648	17621	32A, 415 V T.P	73269099	2458	1	2458
17659	17622	63A, 415 V T.P	73269099	6343	1	6343
17660	17623	100A, 415 V T.P	73269099	10551	1	10551
17670	-	200A, 415 V T.P	73269099	14098	1	14098
2 POLE CHANGE OVER SWITCH PILOT, 240V~ 50Hz						
17717	17627	16A, 415 V	85365090	1492	1	1492
17728	17628	32A, 415 V	85365090	2078	1	2078
3 POLE CHANGE OVER SWITCH PILOT, 240V~ 50Hz						
17819	-	16A, 415 V	85365090	1857	1	1857
17820	-	32A, 415 V	85365090	2352	1	2352
17830	17631	63A, 415 V	85365090	5992	1	5992
4 POLE CHANGE OVER SWITCH PILOT, 240V~ 50Hz						
17910	-	16A, 415 V	85365090	2162	1	2162
17921	17633	32A, 415 V	85365090	3156	1	3156
17932	17634	63A, 415 V	85365090	7400	1	7400
17943	17635	100A, 415 V	85365090	13444	1	13444
PORCELAIN FUSE UNIT PILOT, 240V~ 50Hz						
9297	-	16A, 240V	85361060	70	10	700
9300	-	16A, 415V (32A-240V)	85361060	124	10	1240
9311	-	32A, 415V (63A-240V)	85361060	227	5	1135
9322	-	63A, 415V	85361060	566	1	566
9333	-	100A, 415V	85361060	999	1	999
9480	-	200A, 415V	85361060	1680	1	1680
KITKAT FUSE UNIT WITH BUS BAR LINK, 240V~ 50Hz						
17310	-	63A, 415V	85361060	679	1	679
17311	-	100A, 415V	85361060	1200	1	1200
17312	-	200A, 415V	85361060	2017	1	2017
17309	-	300A, 415V	85361060	2348	1	2348



17182
17615
17626
17692
17637
17637



17648
17659
17660
17670



17717
17728



17819
17820
17830



17910
17921
17932
17943



9297
9300
9311
9322
9333
9480



17310
17311
17312
17309

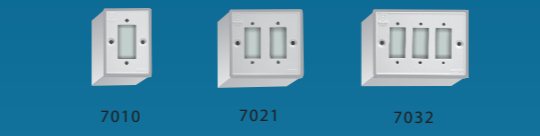

7010
7021
7032



7043
7054
7065



7076



7305
7112
7123



7134
7145



7156
7203



7214
7393



PB0404AW
PB0404BW
PB0407AW
PB0407BW



PB0404CW
PB0404DW
PB0608AW
PB0608BW



PB0810AW
PB0810BW

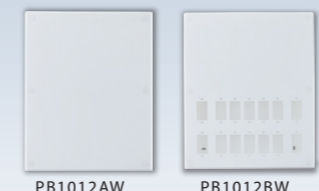

PB1012AW
PB1012BW

SURFACE & DOMESTIC BOXES

Code White	Code Ivory	Description	HSN	Unit Sale Price Rs per number	Standard Packing Quantity (Number)	Maximum Retail Price (Inclusive of all taxes) Rs.
SURFACE MOUNTING BOX FOR SWITCHES						
7010	7010IV	1 Gang Box	85389000	21	20	420
7021	7021IV	2 Gang Box	85389000	31	20	620
7032	7032IV	3 Gang Box	85389000	44	10	440
7043	7043IV	4 Gang Box	85389000	49	10	490
7054	7054IV	5 Gang Box	85389000	56	10	560
7065	7065IV	6 Gang Box	85389000	74	10	740
7076	7076IV	7 Gang Box	85389000	81	10	810
DOMESTIC SURFACE MOUNTING BOX						
7305	7305IV	1 Gang Box	85389000	27	10	270
7112	7112IV	2 Gang Box	85389000	35	20	700
7123	7123IV	3 Gang Box	85389000	48	10	480
7134	7134IV	4 Gang Box	85389000	56	10	560
7145	7145IV	5 Gang Box	85389000	59	10	590
7156	7156IV	6 Gang Box	85389000	76	10	760
7203	7203IV	4 Gang Box (Double Domestic)	85389000	71	10	710
7214	7214IV	5 Gang Box (Double Domestic)	85389000	81	10	810
7393	7393IV	6 Gang Box (Double Domestic)	85389000	87	10	870
DOMESTIC SURFACE MOUNTING BOX						
PB0404AW	PB0404AIV	Plastic Surface Box- 4X4		84	10	840
PB0404BW	PB0404BIV	Plastic Surface Box, 4X4, 1 Way		91	10	910
PB0404CW	PB0404CIV	Plastic Surface Box, 4X4, 2 Way		91	10	910
PB0404DW	PB0404DIV	Plastic Surface Box, 4X4, 3 Way		91	10	910
PB0407AW	PB0407AIV	Plastic Surface Box- 4X7		115	5	575
PB0407BW	PB0407BIV	Plastic Surface Box, 4X7, 4 Way		137	5	685
PB0608AW	PB0608AIV	Plastic Surface Box -6X8		165	5	825
PB0608BW	PB0608BIV	Plastic Surface Box, 6X8, 8 Way		167	5	835
PB0810AW	PB0810AIV	Plastic Surface Box- 8X10		234	5	1170
PB0810BW	PB0810BIV	Plastic Surface Box, 8X10, 9 way DP		247	5	1235
PB1012AW	PB1012AIV	Plastic Surface Box- 10X12		308	5	1540
PB1012BW	PB1012BIV	Plastic Surface Box 10X12, 12 way DP		316	5	1580

Note: These Mounting Boxes are not Suitable for Fan Regulator & Dimmer



TERMS AND CONDITIONS

- 1) Prices are in INR (₹).
- 2) All prices are subject to the general terms and conditions of our business.
- 3) Prices are subject to change without prior notice.
- 4) This price list supersedes all our previous price lists.
- 5) If any dispute should arise it will be subject to Thane jurisdiction.
- 6) Company reserves the right to issue amendments which may arise due to any errors in the price list.
- 7) Colour in images are for reference purpose only, please see product for actual colour.

Due to continuous improvements in product design and development and manufacturing methods, the product may differ in some aspects from the details provided herein.

PANASONIC LIFE SOLUTIONS INDIA PVT. LTD.

Corporate & Head Office: 3rd Floor, B Wing, I-Think Techno Campus,
Pokharan Road No.2, Thane (W), Thane - 400 607, Maharashtra.
Tel. 022 4222 8888 | Fax. 022 4222 8884
Customer Care no.: 022-41304130 | WhatsApp: 9136028606
Email: wecare@in.panasonic.com | www.lsin.panasonic.com

Registered Office: 12th Floor, Ambience Tower, Ambience Island,
NH-48, Gurugram - 122 002, Haryana.

Distributor / Dealer Stamp